



## FC722

Cerberus™ PRO

## Fire control panel



Series FS720 (IP5)

- Compact, prefabricated microprocessor-controlled fire control panel for the connection of up to 252 addresses
- Fire control panel can be used as stand-alone version or networked
- Up to 64 stations (fire control panels and fire terminals) can be connected in one network
- Integrated emergency operation function
- Redundant network node, degrade operation according to EN 54
- Fast Ethernet interface for heterogeneous network
- Integrated user-friendly operating unit
- Optional printer, key switch, LED indicators
- Slots for RS232, RS485 serial ports
- Emergency power supply for up to 72 h emergency power time
- Detection and automatic read-in (auto configuration) of all C-NET devices, providing immediate simple operation
- Processes signals from the Cerberus PRO FD720 detector series
- Floor repeater devices, alarm devices and mimic displays in the detector loop (C-NET)
- Flexible programming of complex applications and controls
- Stored data can be uploaded via remote access
- Firmware download of all processor controlled control panel components

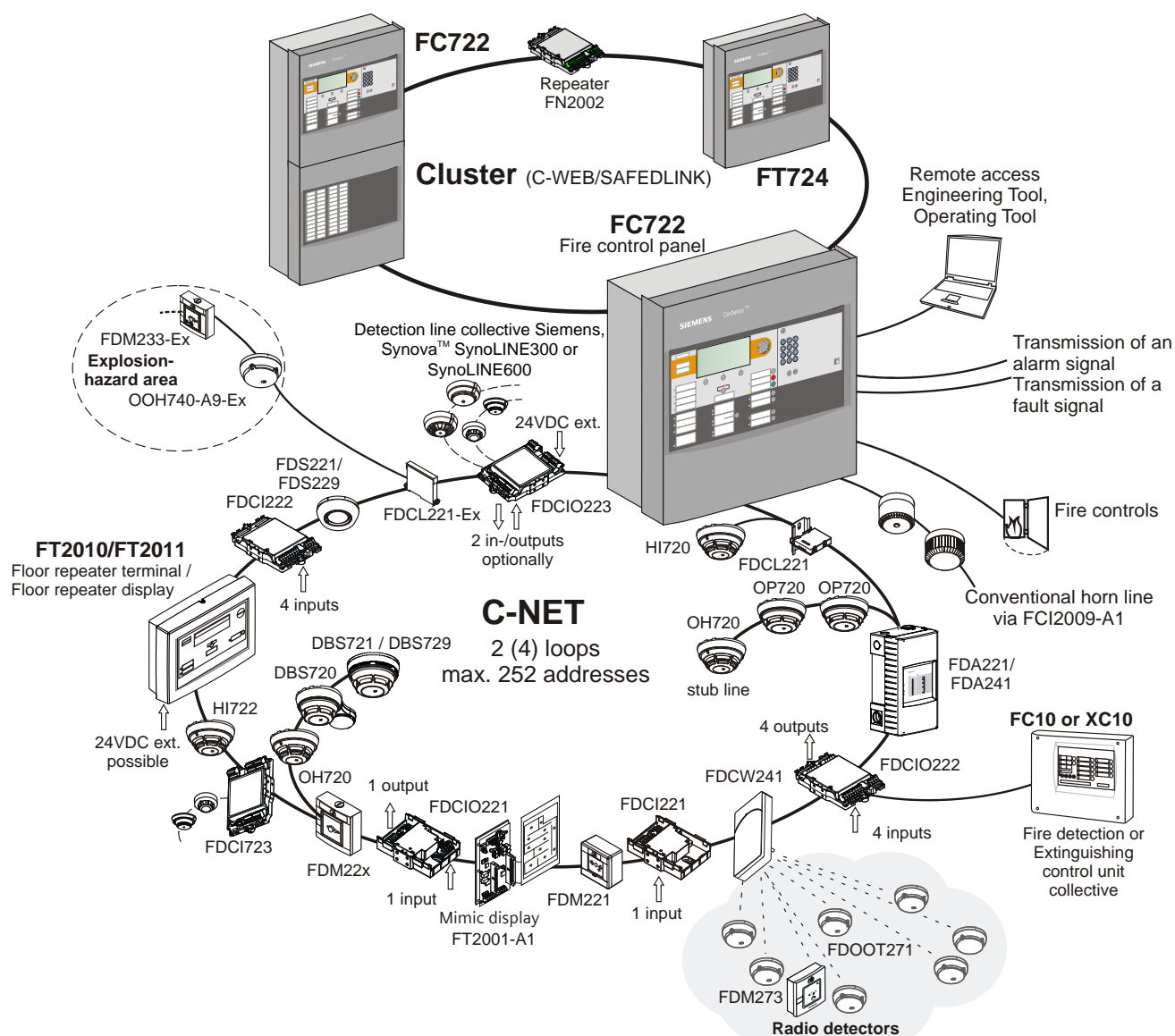

## Networking topologies

Up to 32 fire control panels and fire control terminals can be connected in a single cluster (C-WEB/SAFEDLINK) or up to 16 stations when the cluster is connected to a danger management system.

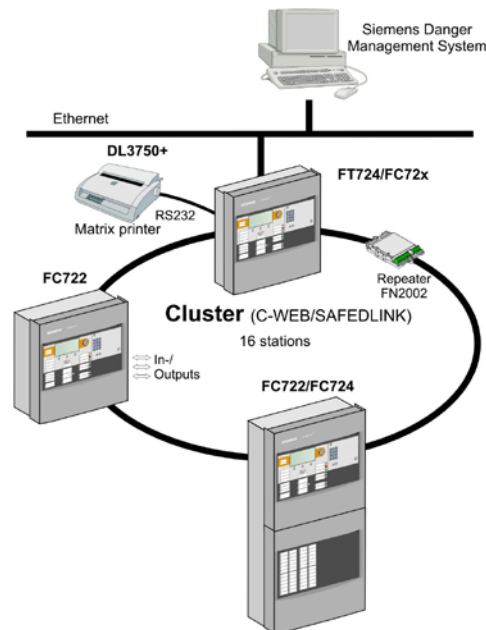

Using a fiber-optic Backbone (C-WEB/LAN) up to 14 of the above mentioned clusters (with up to 16 stations each) can be networked. The entire network may contain up to 64 stations.

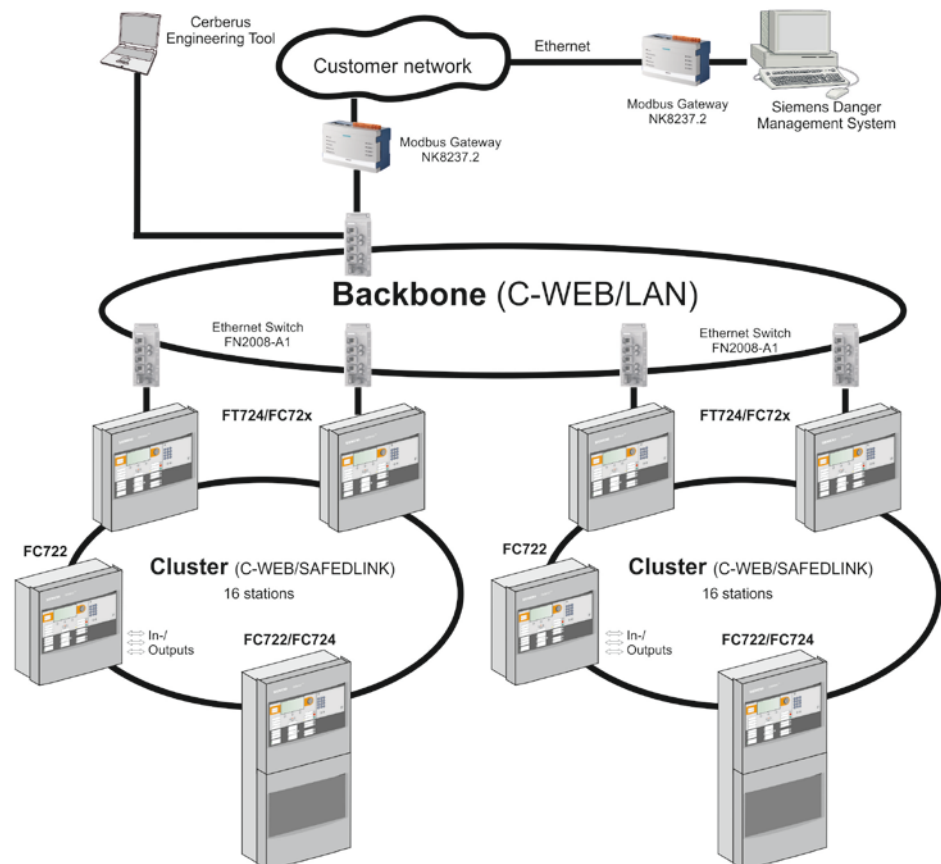

→ For details about system networking, please refer to product data sheet A6V10227649.

## Characteristics

---

- The FC722 is a compact fire control panel with an integrated operating unit that can process signals from FD720 devices.
- The control panel can be used as a stand-alone unit or in a network.
- The control panel can be programmed with the user-friendly Cerberus-Engineering-Tool to create a system with great versatility.
- All detector lines are monitored for ground faults.
- Adaptation of the user text directly on the terminal or with the software engineering tool.
- Up to 2000 events can be stored according to various criteria.
- Automatic summer/winter time change.
- Connection of Siemens Danger Management System

## Functional elements

---

### Operating unit

The following are located on the operating unit:

- CPU module and the electronics for the operating unit
- Ethernet connection
- Slots for RS232, RS485 modules and networking modules (SAFEDLINK)
- Space for 'Kaba' or 'Nordic' key switch
- Space for event printer (except FC722-YZ)

### Periphery board

The following are located on the periphery board:

- Connection terminals for C-NET loops, remote transmission (alarm, fault), horn output, programmable control inputs/outputs, monitored alarm and fault output, degrade supply, power supply
- Plug-in position for loop extension (C-NET)

### Power supply 70 W or 150 W, emergency power supply

The power supply supplies the hardware and charges the batteries

- The batteries supply the emergency power in case of power failure

### Housing

A pivoting mounting panel can be installed on the housing backplane to allow installation of:

- 1 fire brigade periphery module (for Germany)
- 1 sounder module (can also be mounted onto the U-rail TS35)

### Configuration

The FXS7212 Cerberus-Engineering-Tool permits the system to be adapted to specific customers' requirements.

## Application ranges

---

The FC722 is ideally suited for applications, e.g. in workshops, hotels, etc. or when networked as part of much larger applications.









The FC722 can be used by the flexible cross-linking possibilities however also for extensive systems.

## Operation

Each control panel has an integrated operating unit. Additionally the control panel can be operated from another separate FT724 operator terminal.

→ For details and further information, please refer to product data sheet A6V10207898.

## Overview of FC722 fire control panels

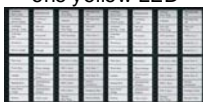
| Housing (Standard)   |   | Housing (Comfort)  |   |
|--|---|--|---|
| <b>FC722-ZZ</b><br><br>2 Loops<br>With power supply (70 W)<br>Battery capacity max. 12 Ah   | <b>FC722-YZ</b><br>With 24 indicator groups<br>with each one red + yellow LED<br><br>2 Loops<br>With power supply (70 W)<br>Battery capacity max. 12 Ah  | <b>FC722-ZA</b><br><br>2 Loops<br>With power supply (150 W)<br>Battery capacity max. 26 Ah   | <b>FC722-ZE</b><br>With 48 indicator groups<br>with each one red + yellow LED<br><br>2 Loops<br>With power supply (150 W)<br>Battery capacity max. 26 Ah |
| <b>FH7202-Z3</b><br>Housing (Standard)<br>430 x 398 x 160 mm<br>Empty housing for various applications<br><br>e.g. for additional batteries,<br>operating add-on or<br>Event printer<br>Space for batteries<br>2 x FA2003-A1 (7 Ah) or<br>2 x FA2004-A1 (12 Ah) or<br>2 x FA2006-A1 (26 Ah) | <b>FH7203-Z3</b><br>Housing (Comfort)<br>430 x 796 x 160 mm<br><br>e.g. for additional batteries,<br>operating add-on or<br>Event printer<br>Space for batteries<br>2 x FA2003-A1 (7 Ah) or<br>2 x FA2004-A1 (12 Ah) or<br>2 x FA2005-A1 (17 Ah) or<br>2 x FA2006-A1 (26 Ah) | <b>FTO2001-A1</b><br>Event printer<br><br>Can be installed in all<br>panels except<br>– FC722-YZ<br>RS232 module must be ordered<br>separately | <b>DL3750+</b><br>Matrix printer (Extern)<br>RS232 interface<br><br>RS232 module must be ordered<br>separately   |
|  |   | <b>Operating add-on</b><br><b>FCM7213-Y3</b><br>48 indicator groups<br>with each one red/green and<br>one yellow LED<br><br>for retrofitting   | <b>FCM7214-Y3</b><br>96 display groups<br>with one red/green and<br>one yellow LED<br><br>for retrofitting   |

## Configuration of FC722 in housing (Standard)

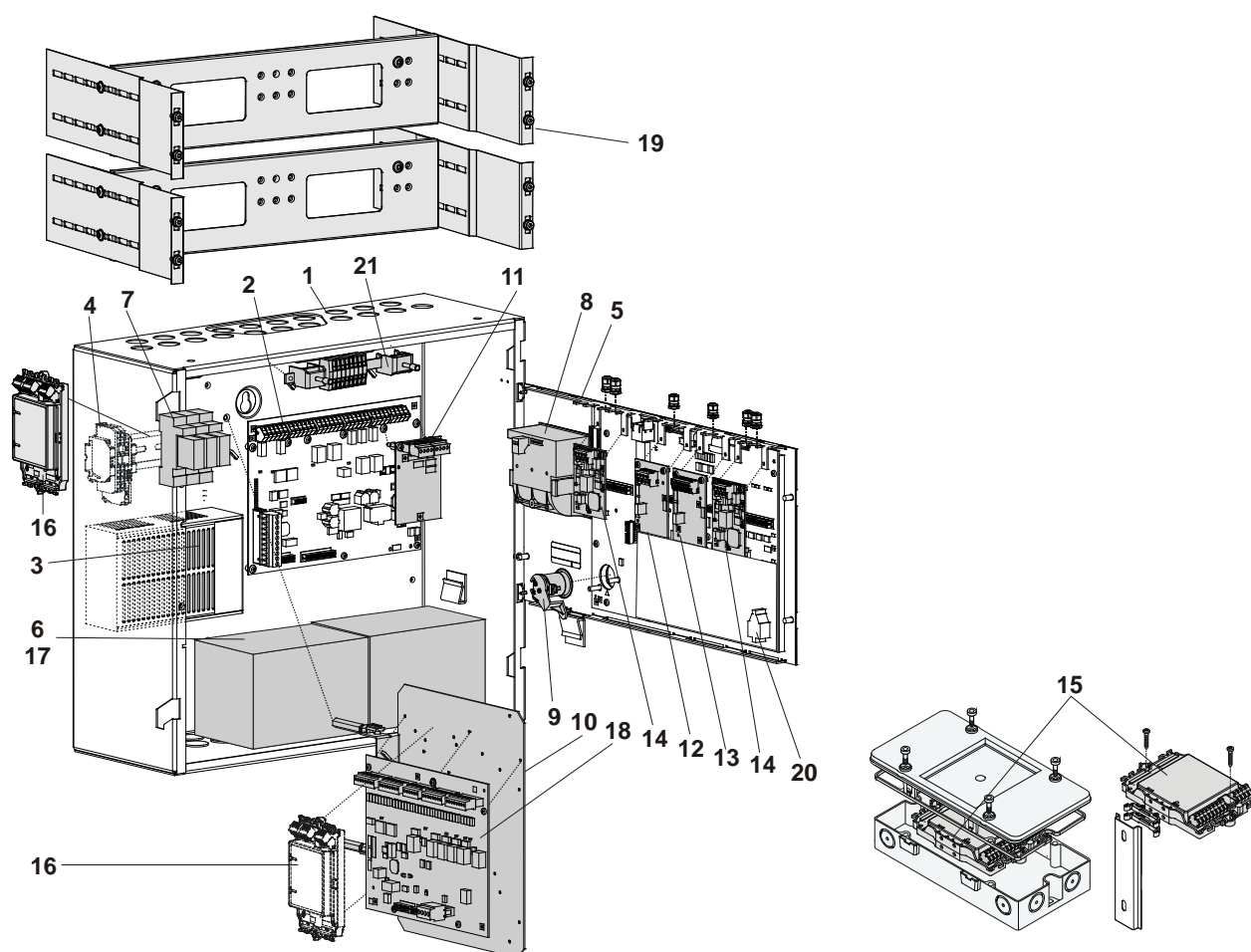

| Basic equipment |   | Designation | Notes   |
|-----------------|---|-------------|---|
| 1               | Rear (Standard)                           | FHA2002-A1  | Pos. 1-5 → Basic equipment for each FC722-xx (Standard)   |
| 2               | Periphery board (2-loop)                  | FCI2002-A1  |   |
| 3               | Power supply (70 W)                       | FP2001-A1   |   |
|                 | Power supply (70 W)                       | FP2015-A1   |   |
| 4               | Mains terminals on DIN mounting rail TS35 | –           |   |
| 5               | Operating unit                            | FCM72xx-xx  | Combined operating unit and CPU, incl. cover  |
| 6               | Space for batteries                       | –           | 2 x 12 V / 7...12 Ah  |
| Expansion       |   |             |   |
| 7               | Relay module                              | Z3B171      | Relay for fire controls   |
| 8               | Event printer                             | FTO2001-A1  | For event logging   |
| 9               | Key switch (Kaba)                         | FTO2005-C1  | For operating access rights   |
|                 | Key switch (Nordic)                       | FTO2006-B1  |   |
| 10              | Mounting plate                            | FHA2007-A1  | E.g. for fire brigade peripheral  |
| 11              | Loop extension (FDnet/C-NET)              | FCI2003-A1  | For loop extension of 2 to 4, number of addresses remains the same  |
| 12              | RS485 module (isolated)                   | FCA2002-A1  | For peripheral devices with RS485 port  |
| 13              | RS232 module (isolated)                   | FCA2001-A1  | For stations with RS232 port  |
| 14              | Networking module (SAFEDLINK)             | FN2001-A1   | For networking various stations   |
| 15              | Repeater (SAFEDLINK)                      | FN2002-A1   | For the extension of the system bus C-WEB, max. 1 between 2 stations (mounting direct onto plane surface, onto a U-rail TS35 or in housing FDCH221) |
| 16              | Sounder module                            | FCA2005-A1  | For split-up of 1 to 4 conventional horn lines  |
| 17              | Battery (12 V, 7 Ah, VDS)                 | FA2003-A1   | For emergency power supply  |
|                 | Battery (12 V, 12 Ah, VDS)                | FA2004-A1   |   |
| 18              | Fire brigade peripheral module            | FCI2001-D1  | For Germany (FBF, FSD, ÜE, FSE, ÖA, KL)   |
| 19              | 19" mounting kit                          | FHA2016-A1  | For the installation in 3 <sup>rd</sup> party housings  |
| 20              | License key Sx                            | FCA20xx     | For special functions   |
| 21              | Cable kit (communication)                 | FCA2014-A1  | For flexible cable connections to the modules on the operating unit   |

## Configuration of FC722 in housing (Comfort)

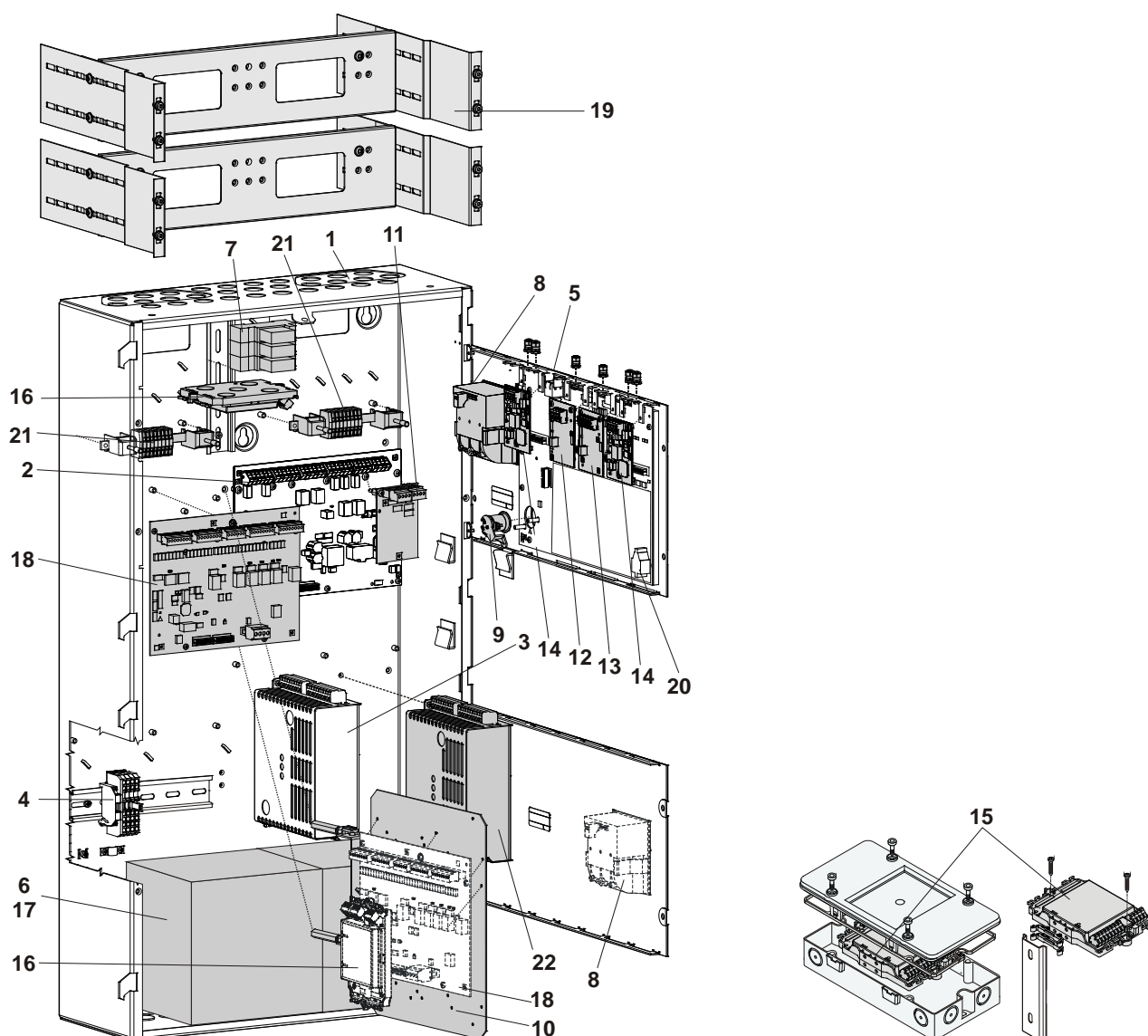





| Basic equipment |   | Designation  | Notes  |
|-----------------|---|--------------|--|
| 1               | Rear (Comfort)                            | FHA2003-A1   | Pos. 1-5 → Basic equipment for each FC722-xx (Comfort)   |
| 2               | Periphery board (2-loop)                  | FCI2002-A1   |  |
| 3               | Power supply (SV 24V-150 W)               | V24230-Z6-A5 |  |
| 4               | Mains terminals on DIN mounting rail TS35 | –            |  |
| 5               | Operating unit                            | FCM72xx-xx   | Combined operating unit and CPU, incl. cover   |
| 6               | Space for batteries                       | –            | 2 x 12 V / 7...26 Ah   |
| Expansion       |   |              |  |
| 7               | Relay module                              | Z3B171       | Relay for fire controls  |
| 8               | Event printer                             | FTO2001-A1   | For event logging  |
| 9               | Key switch (Kaba)                         | FTO2005-C1   | For operating access rights  |
|                 | Key switch (Nordic)                       | FTO2006-B1   |  |
| 10              | Mounting plate                            | FHA2007-A1   | E.g. for fire brigade peripheral   |
| 11              | Loop extension (FDnet/C-NET)              | FCI2003-A1   | For loop extension of 2 to 4, number of addresses remains the same   |
| 12              | RS485 module (isolated)                   | FCA2002-A1   | For peripheral devices with RS485 port   |
| 13              | RS232 module (isolated)                   | FCA2001-A1   | For stations with RS232 port   |
| 14              | Networking module (SAFEDLINK)             | FN2001-A1    | For networking various stations  |
| 15              | Repeater (SAFEDLINK)                      | FN2002-A1    | For the extension of the system bus C-WEB, max. 1 between 2 stations (mounting direct onto plane surface, onto a U-rail TS35 or in housings FDCH221) |
| 16              | Sounder module                            | FCA2005-A1   | For split-up of 1 to 4 conventional horn lines   |

|    |                               |            |   |
|----|-------------------------------|------------|---|
| 17 | Battery (12 V, 12 Ah, VDS)    | FA2004-A1  | For emergency power supply  |
|    | Battery (12 V, 26 Ah, VDS)    | FA2006-A1  |   |
| 18 | Fire brigade periphery module | FCI2001-D1 | For Germany (FBF, FSD, ÜE, FSE, ÖA, KL)                             |
| 19 | 19" mounting kit              | FHA2016-A1 | For the installation in 3 <sup>rd</sup> party housings              |
| 20 | License key L1 or             | FCA2012-A1 | For Cerberus-Remote   |
|    | License key (L2)              | FCA2013-A1 | For Management System (also includes Cerberus-Remote)               |
| 21 | Cable kit (communication)     | FCA2014-A1 | For flexible cable connections to the modules on the operating unit |
| 22 | Power supply kit (150 W, B)   | FP2005-A1  | For additional power supply   |

## Technical data

|   | FC722 in housing (Standard)    | FC722 in housing (Comfort)     |
|---|--------------------------------|--------------------------------|
| Mains voltage                                       | AC 97...127 V / AC 196...253 V | AC 98...127 V / AC 196...253 V |
| Power supply  | 70 W                           | 150 W                          |
| Operating voltage                                   | DC 21...28.6 V                 | DC 21...28.4 V                 |
| Operating current                                   | max. 2.5 A                     | max. 5 A                       |
| Battery capacity                                    | 2 x 12 V, 7... 12 Ah           | 2 x 12 V, 26 Ah                |
| Battery monitoring                                  | yes                            | yes                            |
| Mains monitoring                                    | yes                            | yes                            |
| Connectable detector series                         | Cerberus PRO FD720 (C-NET)     | Cerberus PRO FD720 (C-NET)     |
| Number of lines                                     |                                |                                |
| – Loops (with loop extension) or                    | 2 (4)                          | 2 (4)                          |
| – Stub lines  | 4 (8)                          | 4 (8)                          |
| Number of addresses                                 | max. 252                       | max. 252                       |
| Integrated inputs/outputs                           |                                |                                |
| – Relay output                                      |                                |                                |
| – Remote transmission alarm                         | 1                              | 1                              |
| – Remote transmission fault                         | 1                              | 1                              |
| – Monitored outputs                                 |                                |                                |
| – Alarm   | 1                              | 1                              |
| – Fault   | 1                              | 1                              |
| – Horn  | 1                              | 1                              |
| – Free programmable inputs/outputs                  | 8                              | 8                              |
| Operating unit                                      | integrated                     | integrated                     |
| Plug-in position for serial interfaces RS232, RS485 | 2                              | 2                              |
| Plug-in position for network module                 | 2                              | 2                              |
| Plug-in position for loop extension                 | 1                              | 1                              |
| Mounting place for cable kit (communication)        | 1                              | 2                              |
| Sounder module                                      | max. 1                         | max. 1                         |
| Ethernet connection RJ45                            | 1                              | 1                              |
| Operating temperature                               | -8...+42 °C                    | -8...+42 °C                    |
| Storage temperature                                 | -20...+60 °C                   | -20...+60 °C                   |
| Humidity (no condensation permitted)                | ≤95 % rel.                     | ≤95 % rel.                     |
| Dimensions (B x H x T)                              |                                |                                |
| – Without cover cap                                 | 430 x 398 x 160 mm             | 430 x 796 x 160 mm             |
| – With cover cap                                    | 430 x 398 x 188 mm             | 430 x 796 x 188 mm             |
| Color   |                                |                                |
| – Housing   | grey, ~RAL 7035                | grey, ~RAL 7035                |
| – Cover   | grey, ~RAL-Design 000 50 00    | grey, ~RAL-Design 000 50 00    |
| Protection category (IEC 60529)                     | IP30                           | IP30                           |
| Approvals   |                                |                                |
| – VdS   | G209076                        | G209076                        |
| – LPCB  | 126bn/06                       | 126bn/06                       |
| – FM  | approved                       | approved                       |



|   |   |      |                  |  |
|---|---|------|------------------|--|
| 09  |  | 0786 | <b>FC722</b>     | Siemens Switzerland Ltd; Gubelstrasse 22<br>CH-6301 Zug<br>Technical data: see doc. <b>A6V10210355</b> |
| FC722 - Control and Indicating Equipment incl. FP2001 or FP2015 - 70W/24VDC or SV24V150W - 150W/24VDC Power Supply Equipment for use in fire detection and fire alarm systems installed in buildings  |   |      |                  |  |
| 305/2011/EU (CPR): EN 54-2 / EN 54-4 ; 2004/108/EC (EMC): EN 50130-4 / EN 61000-6-3 ; 2006/95/EC (LVD): EN 60950-1 ; 2011/65/EU (RoHS): EN 50581  |   |      |                  |  |
| Declared performance and conformity can be seen in the Declaration of Performance and the EC Declaration of Conformity, which is obtainable via the Customer Support Center: Tel. +49 89 9221-8000 or <a href="http://siemens.com/bt/download">http://siemens.com/bt/download</a> |   |      |                  |  |
| DoP No.: 0786-CPR-20767; DoC No.: CED-FC722   |   |      |                  |  |
| 07  |  | 0786 | <b>FP2001</b>    | Siemens Switzerland Ltd; Gubelstrasse 22<br>CH-6301 Zug<br>Technical data: see doc. <b>008837</b>      |
| FP2001 - Power Supply Equipment 24V/70W for use in fire detection and fire alarm systems installed in buildings   |   |      |                  |  |
| 305/2011/EU (CPR): EN 54-4 ; 2004/108/EC (EMC): EN 50130-4 / EN 61000-6-3 ; 2006/95/EC (LVD): EN 60950-1 ; 2011/65/EU (RoHS): EN 50581  |   |      |                  |  |
| Declared performance and conformity can be seen in the Declaration of Performance and the EC Declaration of Conformity, which is obtainable via the Customer Support Center: Tel. +49 89 9221-8000 or <a href="http://siemens.com/bt/download">http://siemens.com/bt/download</a> |   |      |                  |  |
| DoP No.: 0786-CPR-20266; DoC No.: CED-FP2001  |   |      |                  |  |
| 14  |  | 0786 | <b>FP2015</b>    | Siemens Switzerland Ltd; Gubelstrasse 22<br>CH-6301 Zug<br>Technical data: see doc. <b>A6V10411051</b> |
| FP2015 - Power Supply Equipment 24V/70W for use in fire detection and fire alarm systems installed in buildings   |   |      |                  |  |
| 305/2011/EU (CPR): EN 54-4 ; 2004/108/EC (EMC): EN 50130-4 / EN 61000-6-3 ; 2006/95/EC (LVD): EN 60950-1 ; 2011/65/EU (RoHS): EN 50581  |   |      |                  |  |
| Declared performance and conformity can be seen in the Declaration of Performance and the EC Declaration of Conformity, which is obtainable via the Customer Support Center: Tel. +49 89 9221-8000 or <a href="http://siemens.com/bt/download">http://siemens.com/bt/download</a> |   |      |                  |  |
| DoP No.: 0786-CPR-21302; DoC No.: CED-FP2015  |   |      |                  |  |
| 13  |  | 0786 | <b>SV24V150W</b> | Siemens Switzerland Ltd; Gubelstrasse 22<br>CH-6301 Zug<br>Technical data: see doc. <b>008837</b>      |
| SV24V150W - Power Supply Equipment 24VDC/150W for use in fire detection and fire alarm systems installed in buildings   |   |      |                  |  |
| 305/2011/EU (CPR): EN 54-4 ; 2004/108/EC (EMC): EN 50130-4 / EN 61000-6-3 ; 2006/95/EC (LVD): EN 60950-1 ; 2011/65/EU (RoHS): EN 50581 ;  |   |      |                  |  |
| Declared performance and conformity can be seen in the Declaration of Performance and the EC Declaration of Conformity, which is obtainable via the Customer Support Center: Tel. +49 89 9221-8000 or <a href="http://siemens.com/bt/download">http://siemens.com/bt/download</a> |   |      |                  |  |
| DoP No.: 0786-CPD-20775; DoC No.: CED-SV24V150W   |   |      |                  |  |

## Details for ordering

|                         | Type       | Part no         | Designation  | Weight    |
|-------------------------|------------|-----------------|--|-----------|
| Fire control panels     | FC722-ZZ   | S54400-C29-A5   | Fire control panel (2L)                                    | 10.660 kg |
|                         | FC722-YZ   | S54400-C29-A4   | Fire control panel (2L, 1LED)                              | 10.500 kg |
|                         | FC722-ZA   | S54400-C29-A2   | Fire control panel (2L)                                    | 18.250 kg |
|                         | FC722-ZE   | S54400-C29-A1   | Fire control panel (2L, 2LED)                              | 20.850 kg |
| Expansion               | Z3B171     | BPZ:4843830001  | Relay module 250 VAC / 10 A (1 relay)                      | 0.042 kg  |
|                         | FTO2001-A1 | A5Q00010126     | Event printer  | 0.250 kg  |
|                         | –          | A5Q00017619     | Replacement printer rolls (10 rolls)                       | 0.090 kg  |
|                         | FTO2005-C1 | A5Q00010113     | Key switch (Kaba)  | 0.013 kg  |
|                         | FTO2006-B1 | A5Q00010129     | Key switch (Nordic)  | 0.050 kg  |
|                         | FHA2007-A1 | A5Q00010151     | Mounting plate   | 0.800 kg  |
|                         | FCI2003-A1 | A5Q00010136     | Loop extension (FDnet/C-NET)                               | 0.064 kg  |
|                         | FCA2002-A1 | A5Q00009923     | RS485 module (isolated)                                    | 0.067 kg  |
|                         | FCA2001-A1 | A5Q00005327     | RS232 module (isolated)                                    | 0.068 kg  |
|                         | FN2001-A1  | A5Q00012851     | Network module (SAFEDLINK)                                 | 0.077 kg  |
|                         | FN2002-A1  | S24236-B2502-A1 | Repeater (SAFEDLINK)                                       | 0.154 kg  |
|                         | FCA2005-A1 | A5Q00014866     | Sounder module   | 0.140 kg  |
|                         | FCA2014-A1 | A5Q00023027     | Cable kit (communication)                                  | 0.224 kg  |
|                         | FCI2001-D1 | A5Q00013100     | Fire brigade periphery module                              | 0.482 kg  |
|                         | FH7202-Z3  | S54400-B70-A101 | Housing (Standard)   | 7.500 kg  |
|                         | FH7203-Z3  | S54400-B71-A101 | Housing (Comfort)  | 15.000 kg |
|                         | FCM7213-Y3 | S54400- B149-A1 | Operating add-on (2xLED-ind.)                              | 2.600 kg  |
|                         | FCM7214-Y3 | S54400- B150-A1 | Operating add-on (4xLED-ind.)                              | 2.800 kg  |
|                         | FHA2016-A1 | A5Q00020179     | 19" mounting kit   | 3.000 kg  |
|                         | FN2006-A1  | S54400-A109-A1  | Fiber network module (SM)                                  | 0.770 kg  |
|                         | FN2007-A1  | S54400-A110-A1  | Fiber network module (MM)                                  | 0.770 kg  |
| Additional power supply | FP2003-A1  | A5Q00016005     | Power supply kit (70 W)                                    | 0.650 kg  |
|                         | FP2015-A1  | S54400-B121-A1  | Power supply (70 W)  | 1.300 kg  |
|                         | FP2004-A1  | A5Q00020825     | Power supply kit (150 W) for installation in empty housing | 1.366 kg  |
|                         | FP2005-A1  | A5Q00018779     | Power supply kit (150 W, B) for cascading                  | 1.100 kg  |
| Networks (backbone)     | FN2008-A1  | S54400-F94-A1   | Ethernet switch  | 0.800 kg  |
|                         | NK8237.2   | S54461-C7-A1    | Modbus GW  | 0.603 kg  |
|                         | FHA2029-A1 | S54400-B79-A1   | Mounting kit for Ethernet switch (Comfort)                 | 0.500 kg  |
|                         | FHA2030-A1 | S54400-B81-A1   | Mounting kit for Ethernet switch (Large Ext.)              | 0.500 kg  |
| Batteries               | FA2003-A1  | A5Q00019353     | Battery (12 V, 7 Ah, VDS)                                  | 2.450 kg  |
|                         | FA2004-A1  | A5Q00019354     | Battery (12 V, 12 Ah, VDS)                                 | 3.930 kg  |
|                         | FA2005-A1  | A5Q00019677     | Battery (12 V, 17 Ah, VDS)                                 | 5.640 kg  |
|                         | FA2006-A1  | A5Q00019356     | Battery (12 V, 26 Ah, VDS)                                 | 7.572 kg  |
| License keys            | FCA2033-A1 | S54400-P154-A1  | License key (S1)   | 0.010 kg  |
|                         | FCA2034-A1 | S54400-P155-A1  | License key (S2)   | 0.010 kg  |
|                         | FCA2035-A1 | S54400-P156-A1  | License key (S3)   | 0.010 kg  |
| External printer        | DL3750+    | A5Q00023962     | Matrix printer (Extern)                                    | 7.300 kg  |
| Spare part              | –          | A5Q00023963     | Black typewriter ribbon for matrix printer DL3750+         | 0.078 kg  |